

# **“CreatorPRO” Software User’s Guide**



Welcome to CreatorPRO, the software we created in order to let you create new recipes for your HotmixPRO.

All the necessary files to install the software are already on your SD card.

In the same folder as this file (the "CreatorPRO" folder), you find 2 files:  
"setup.exe" and "Creative\_setup.msi".  
(they may appear simply as "setup" and "Creative\_setup")

Please double-click on "setup.exe" in order to begin the installation procedure.  
The procedure will guide you through the installation in a plain and easy way, just confirm the settings and you'll be done.

When you launch CreatorPRO, make sure you have your SD card already inserted into the PC.

This is the first screen you'll encounter.

Click on Save in order to start creating a new recipe.

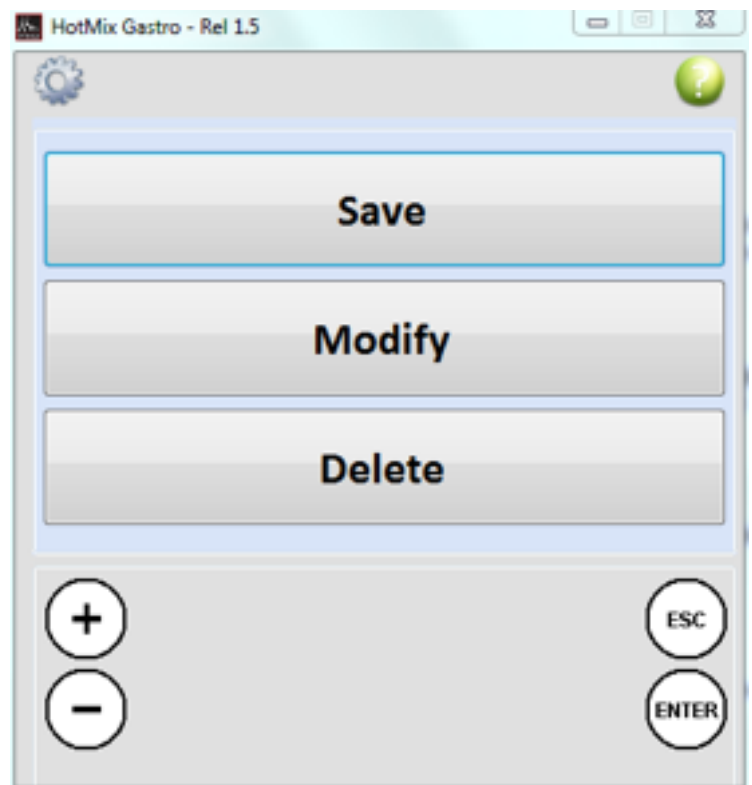

At first, you will have to insert a title for your recipe.

Press ENTER when done, to confirm and proceed.



Then you'll get to the screen with the actual recipe settings.

Set freely the SPEED, TIME and TEMPERATURE for your recipe, along with the accessories.

**WARNING:**

a tool is required;  
you don't have to set both TIME, SPEED and TEMPERATURE, as the machine does not need all 3 parameters (more on included instructions manual) but if you don't set a TEMPERATURE, you must set at least a SPEED, and vice-versa.

If you need them, select also PULSE, Wait Temp and Next.



**PULSE 1:**

50% of time working at selected speed, 50% OFF. Any set speed.

**PULSE 2:**

Interrupts the work for 2 seconds, every 10 seconds. 10 seconds at the selected speed, 2 seconds stop, 10 seconds at the selected speed... and so on.

**WAIT TEMP. :**

If you flag this option, the TIME will be counted down only since the machine has reached the set temperature. (e.g. "start the countdown when you've reached 146°C")

**NEXT:**

If you flag this option, you are stating that the new STEP which will not present any ingredient modification. Useful, for instance, in order to keep mixing/keep the temperature on a otherwise finished recipe.

Simply said, the passage to this STEP will not require your intervention.

The machine will pass **from the previous STEP to this one** (useless on the first STEP) alone, without stopping and without playing any alarm to ask for your attention.

Press ENTER to confirm and proceed.

On the next screen, you will have the chance to either insert a new STEP, add indications for an ingredient (to the STEP you just set up), or end the recipe as is.



In order to add one or more ingredients to the step you just edited, select “new ingredient” and you will find this screen.

Insert the name of the chosen ingredient in the text field, the measuring unit (grams, deciliters, or number of units) and the quantity in the two fields below. This ingredient will now appear in the on-screen instructions provided by the machine while operating: it is a useful reminder!

Once done, you’ll get back to the previous screen; add STEPs and ingredients as needed, then select END when the recipe is complete.

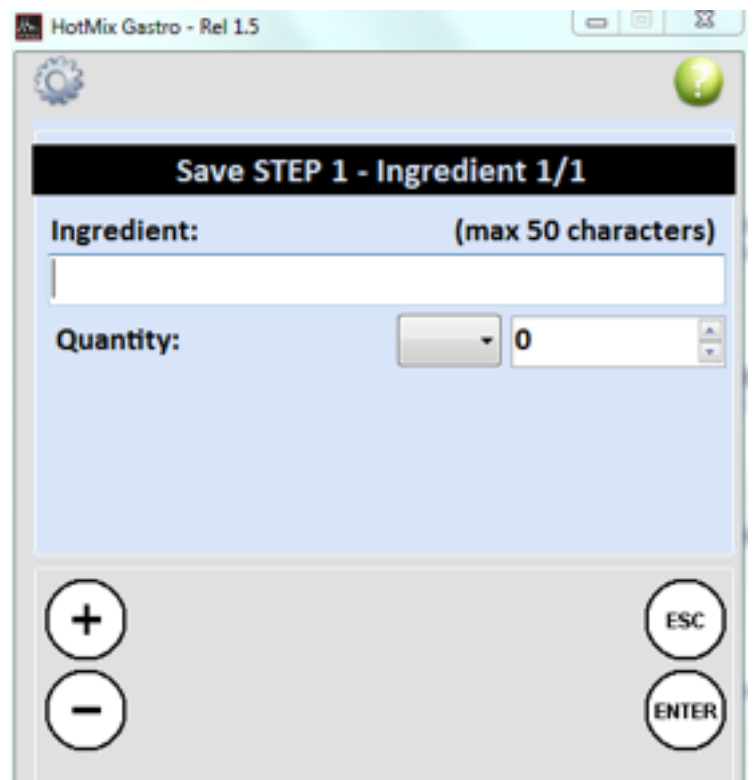

If you want to modify a recipe you already created, select “Modify”.

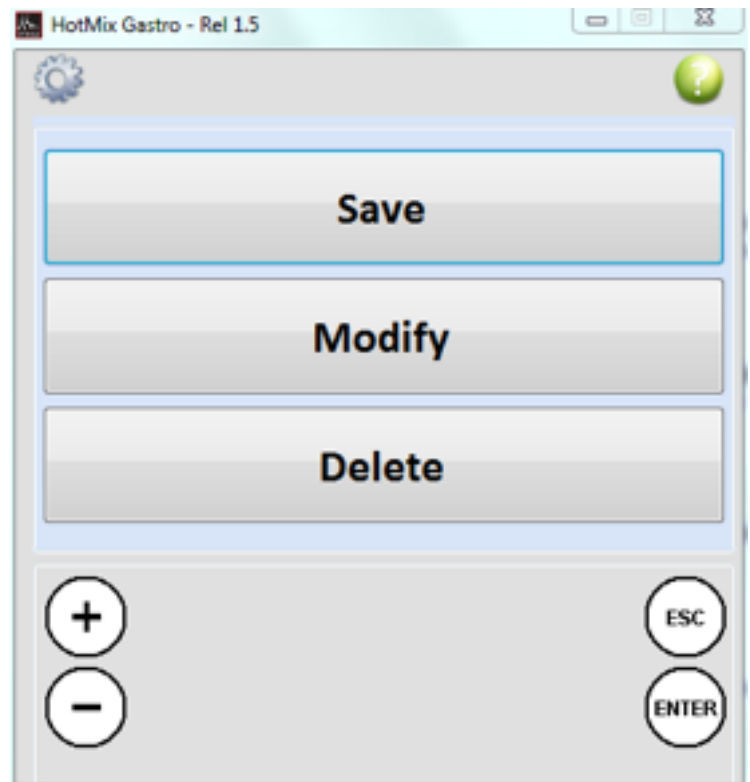

By selecting “Modify”, you will be prompted with the list of the recipes you created.

In this example, made just for the tutorial, the only recipe we see is “TEST RECIPE”.



At first, you will be able to modify the title. Change it as needed, or leave it as it is, then proceed by pressing “ENTER”.

HotMix Gastro - Rel 1.5

**Modify Recipe**

Recipe Title: (max 50 characters)

TEST RECIPE

+ - ESC ENTER

When you're done with the title, you can add, modify, or delete STEPS and/or ingredients.

HotMix Gastro - Rel 1.5

**Modify Recipe**

NEW STEP  
EDIT STEP  
DELETE STEP  
NEW INGREDIENT  
MODIFY INGREDIENT

+ - ESC ENTER

The procedures are the same as in the creation phase... except -of course- that you will find all the fields already filled, as per your previous settings.

HotMix Gastro - Rel 1.5

**Modify Recipe - STEP 2/2**

Speed: no Pulse 1

☐ Time (hh:mm:ss): 00:00:00

☐ Temperature (°C): 25

Tool:

Functions: ☐ Wait Temp ☐ Next

+ - ESC ENTER

HotMix Gastro - Rel 1.5

**Modify STEP 2 - Ingredient 2/2**

Ingredient: (max 50 characters)

TEST INGREDIENT

Quantity: 0

+ - ESC ENTER



Last but not least, you have the chance to delete a recipe.

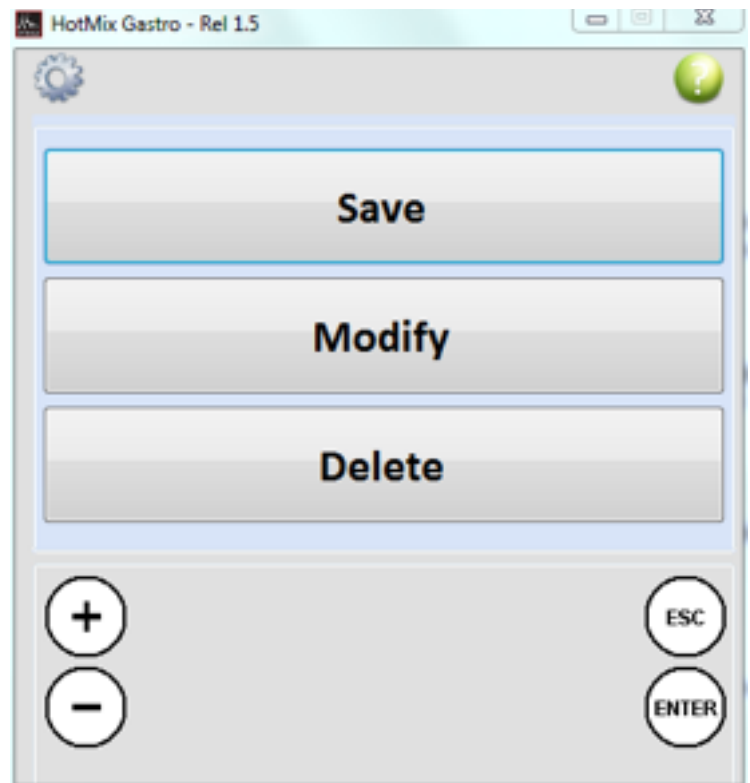

Select “delete” and you will see a list of all the recipes you previously created (in this example, only our “TEST RECIPE”).

Check the box next to the recipes you want to delete, and proceed with enter.

Just remember that the recipes you delete will be lost!

TIP: backup the folder named USER in your SD card. You’ll be able to revert any modification you’ll make.

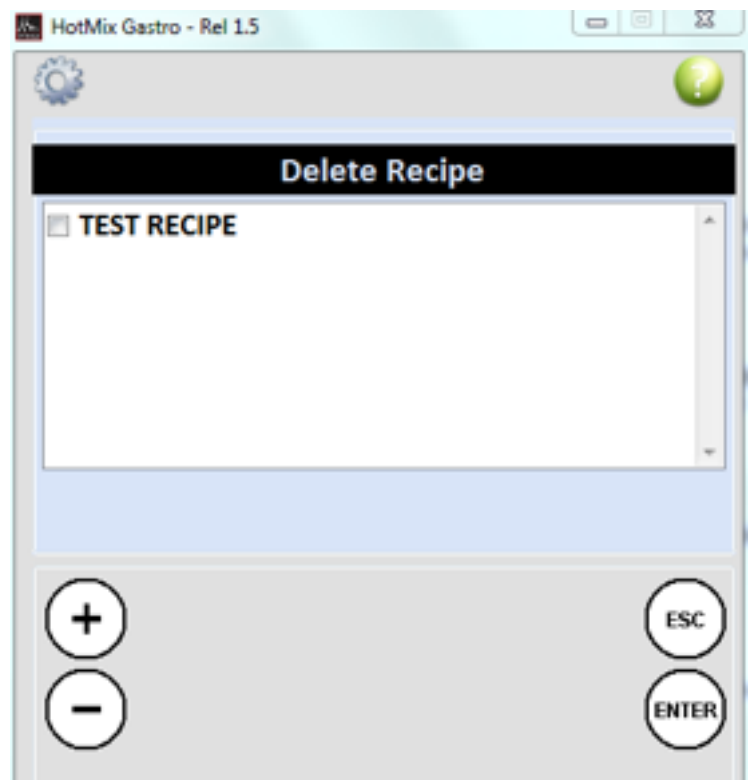

**That was all... Enjoy creating new recipes with your new HotmixPRO!**



**Hotmix<sup>®</sup>PRO**

THE PROFESSIONAL THERMAL MIXER

made in Italy